



EKIPA

0094NOTIC6264



LOGE TOUT

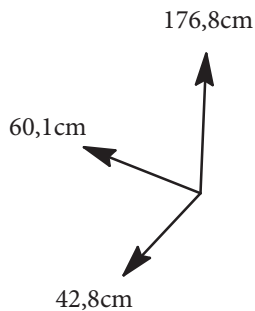
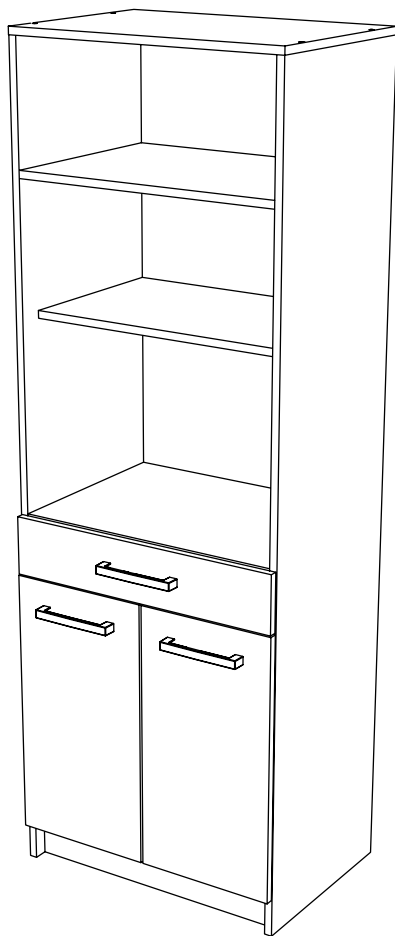

FR Remerciements :

Nous vous remercions d'avoir choisi un meuble créé et fabriqué par Ekipa et espérons qu'il vous donnera entière satisfaction.

EN Thanks :

Thank you for choosing furniture designed and manufactured by Ekipa. We hope you are totally satisfied your purchase.

ES Agradecimientos :

Les damos las gracias por haber elegido un mueble diseñado y fabricado por el Ekipa y esperamos que sea de su total agrado.

DE Danksagung:

Wir danken Ihnen für den Kauf eines Frankreich von der Ekipa entworfenen und hergestellten Möbelstücks und hoffen, dass Sie es zu Ihrer vollkommenen Zufriedenheit finden werden.



Temps de montage : 1h30



contact@parisot.com



Conseils de préparation au montage : 15 min

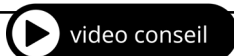

<https://qrco.de/bcJeNz>

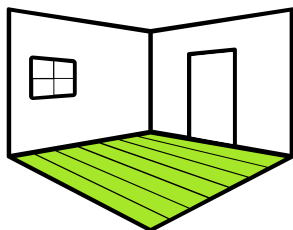

Faire un peu de place

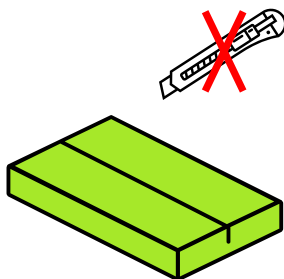

Pas d'outils tranchants

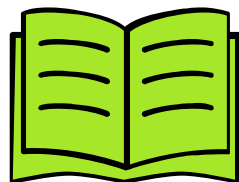

Bien suivre les instructions
de la notice de montage

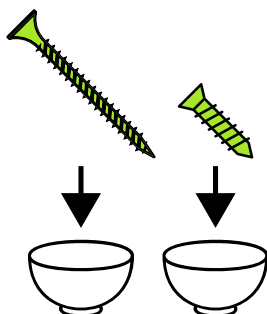

Trier vos quincailleries

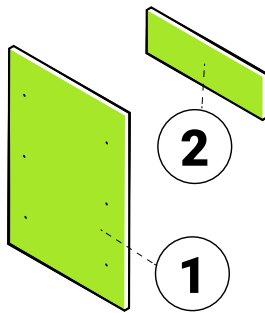

Repérer vos pièces

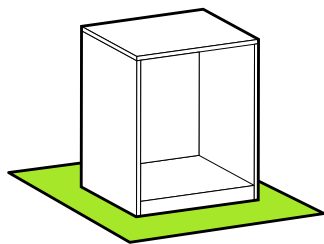

Protéger votre sol

Matériel nécessaire

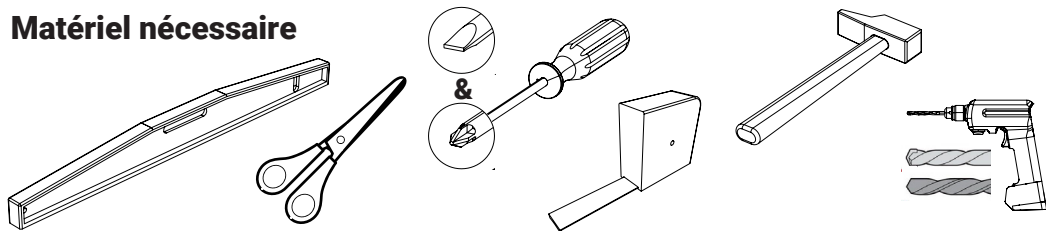

Conseils d'entretien

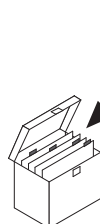

Rep	Qté	cm		
01	1	174,8	41	1,6
02	1	174,8	41	1,6
03	3	56,8	40,9	1,6
04	1	60,1	41	1,6
05	1	56,8	8	1,6
06	1	56,8	36	1,6
07	1	70,2	59,6	0,25
08	1	59,6	57,2	0,25
09	1	56,7	35,8	1,6
10	1	59,5	12,5	1,6
11	1	54,5	39,4	0,25
12	1	134,9	8	1,25
13	2	57,4	29,6	1,6

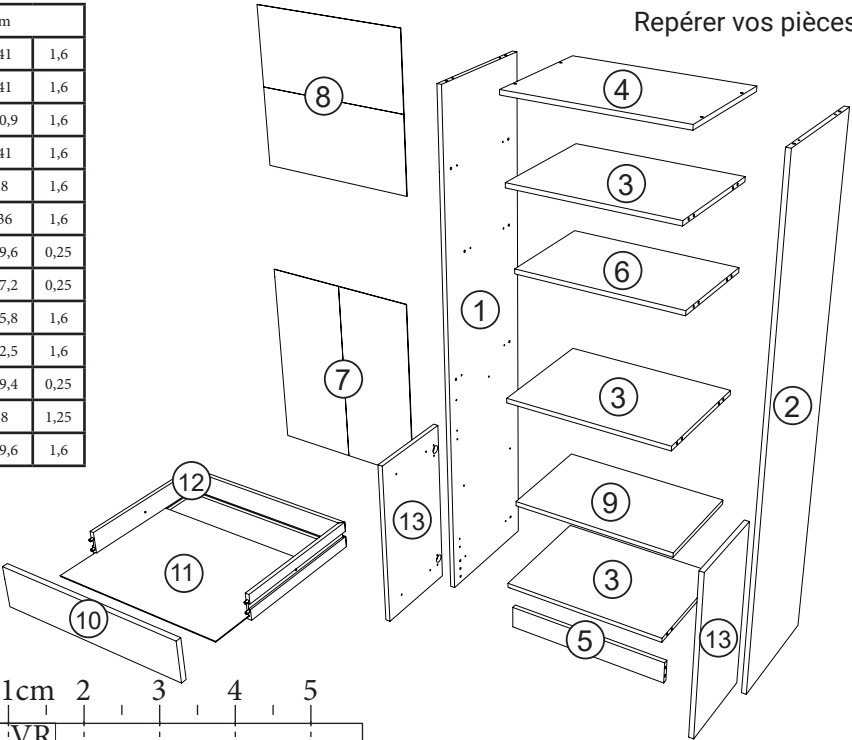

	0	1cm	2	3	4	5
	VR		x2			
	15mm VAF8		x2			
	13mm VG		x2			
	12mm BWF		x4			
	CDS		x16			
	ADM		x24			
	HW		x4			

Trier vos quincailleries

CF x1	HV x1	BQS x4
AI x16	BSD x16	PA x30
BWD x4	CDD x4	CDA x4
CP x1	ZK x1	
OO x4	PB x3	PAS x2

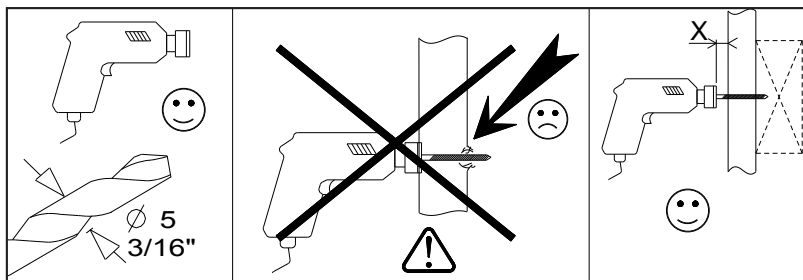
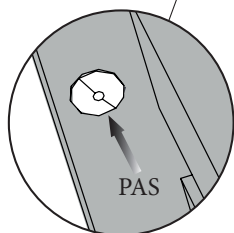
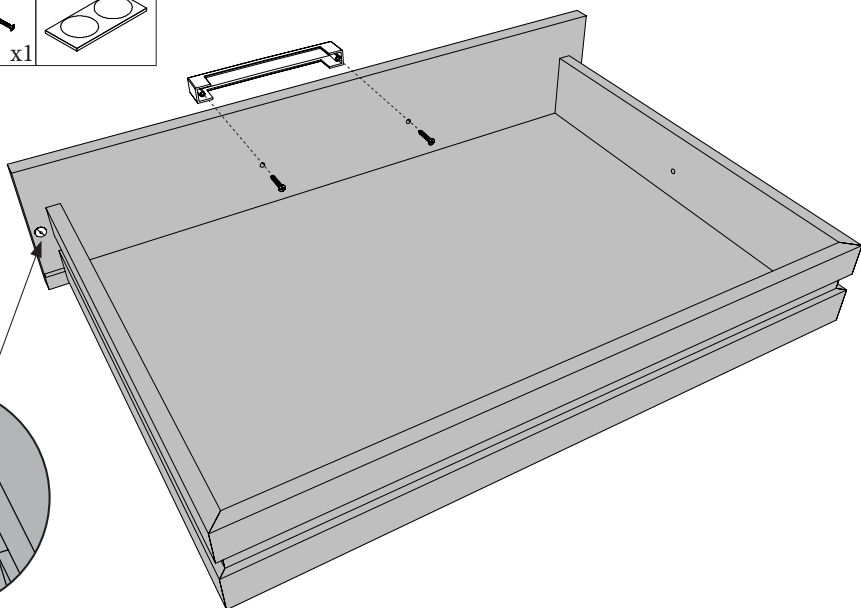
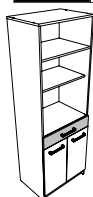
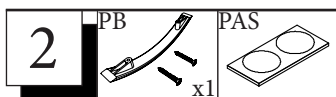
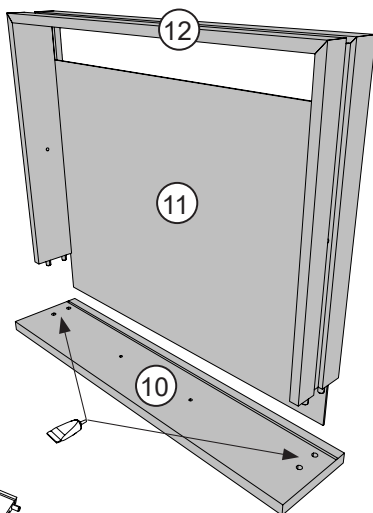
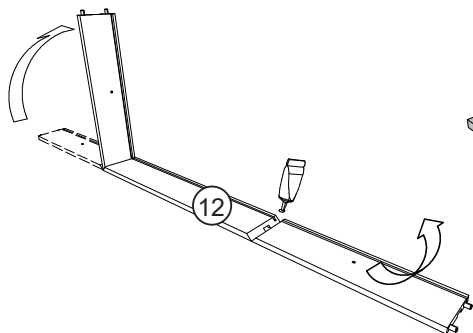
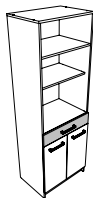
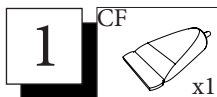

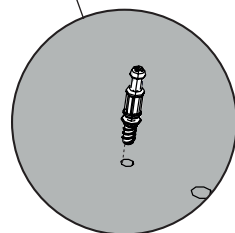
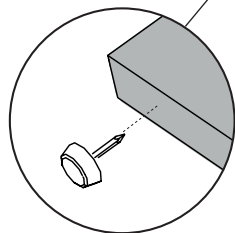
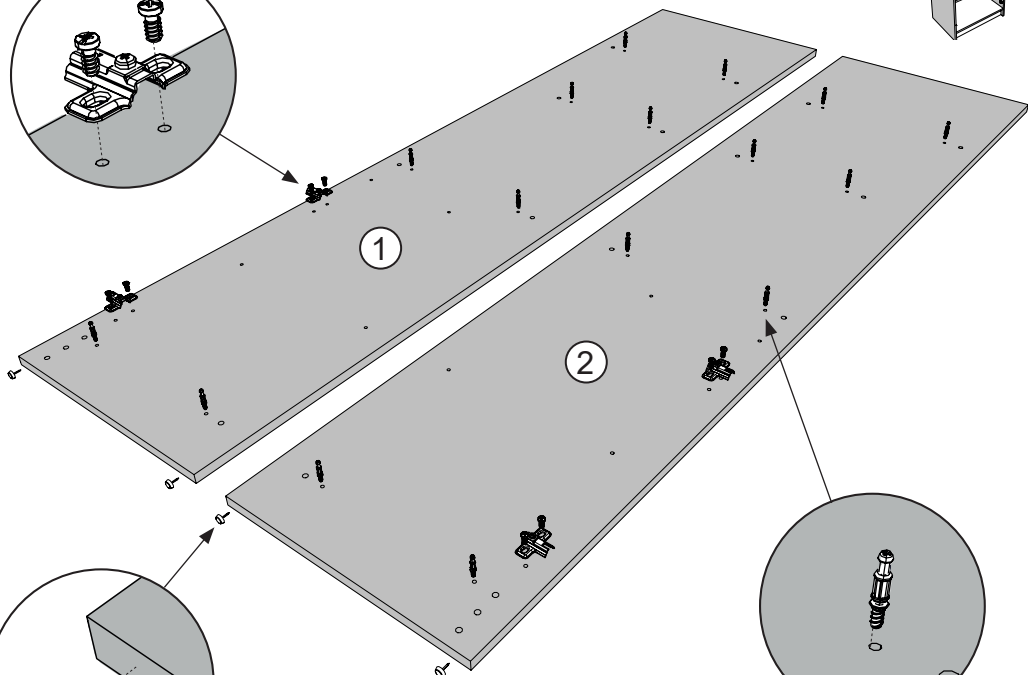
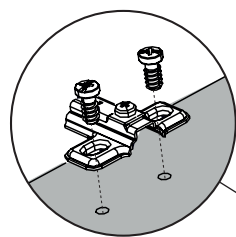
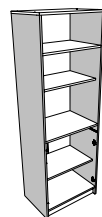
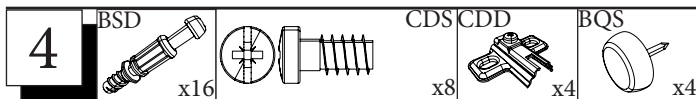
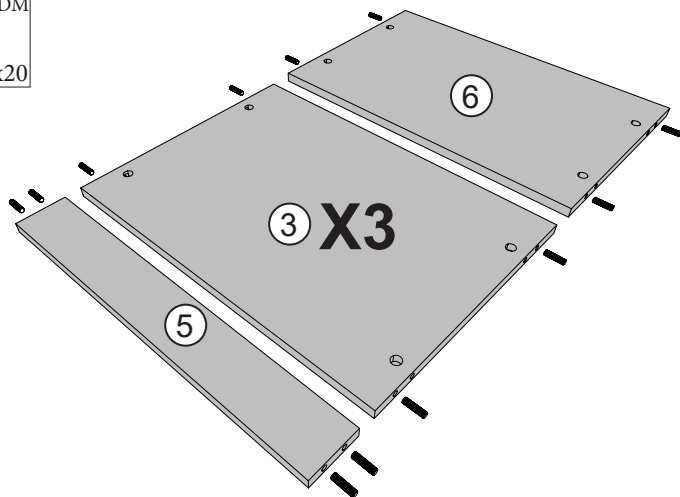
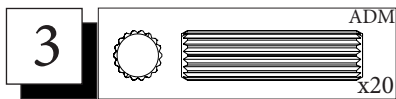

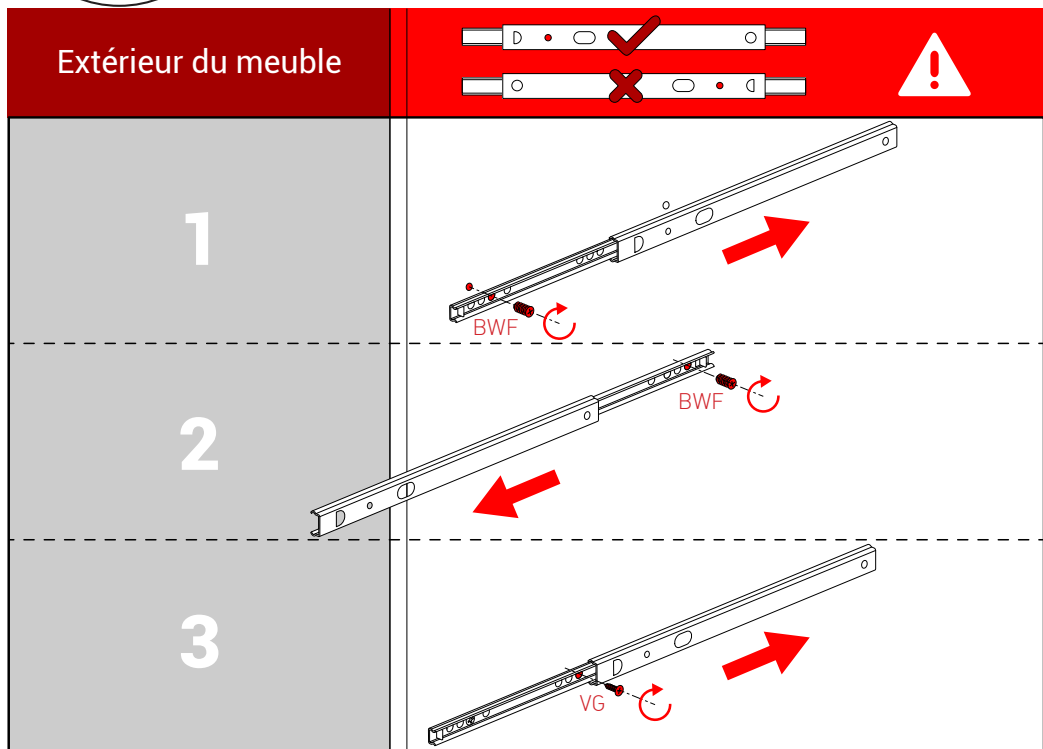
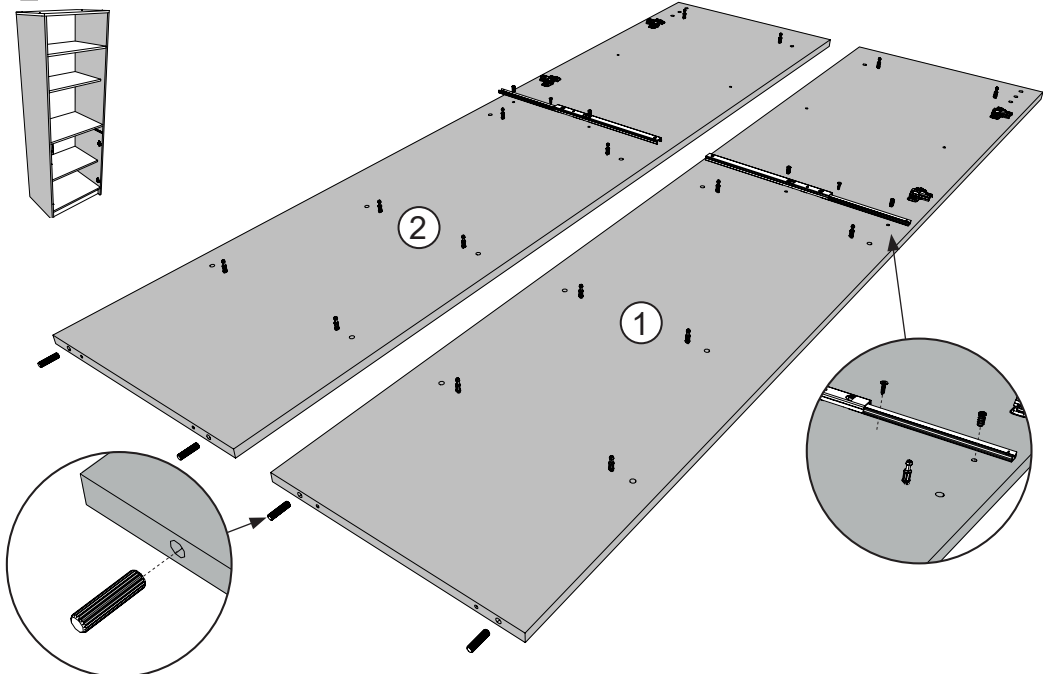
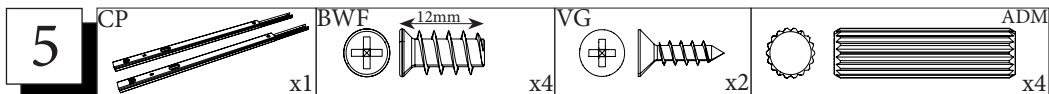

6  x16

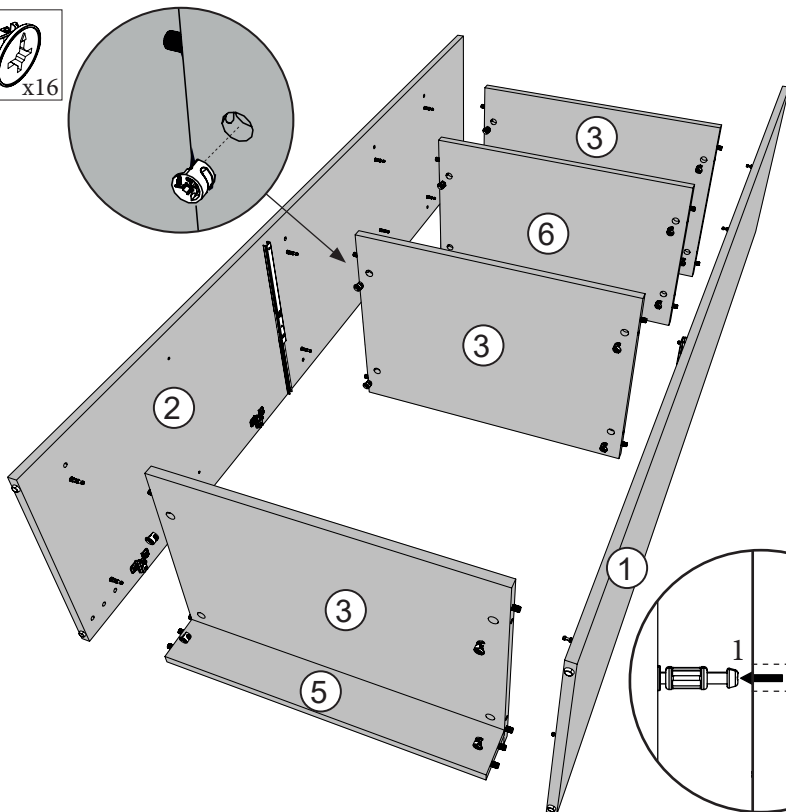
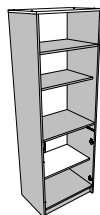

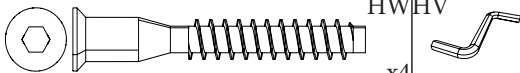
7  HW HV x4

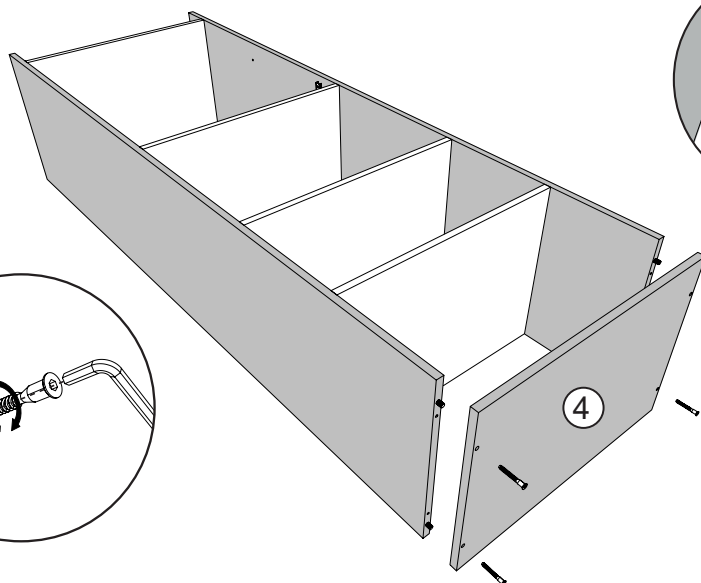
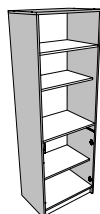

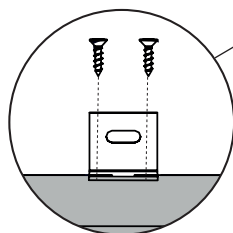
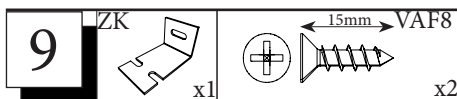
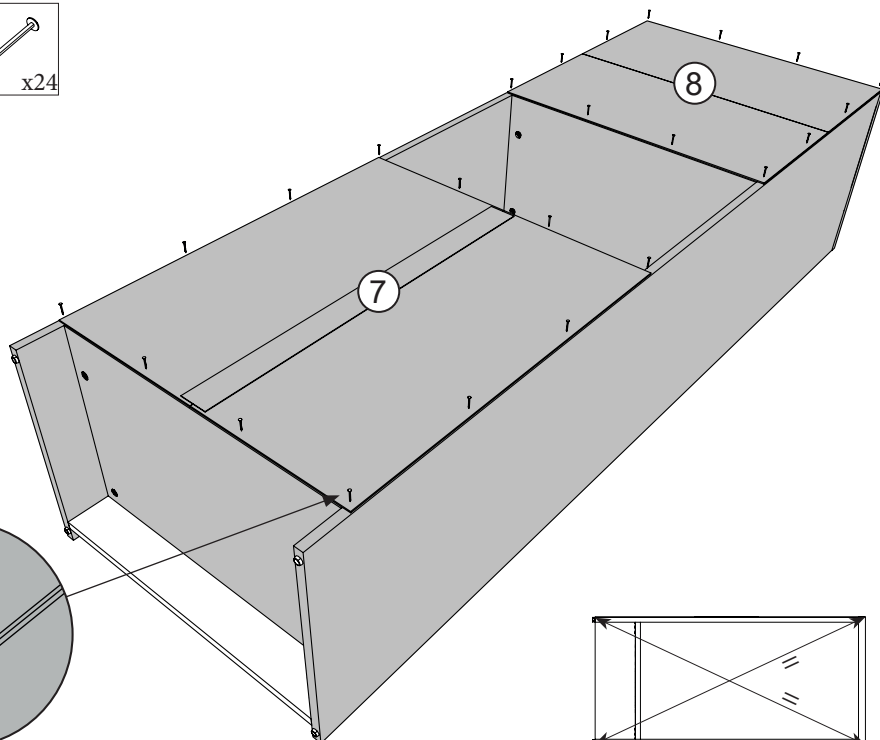
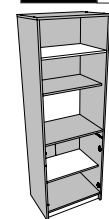
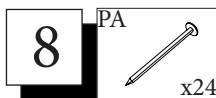

FR Pour votre sécurité: Fixation du meuble au mur. Attention, la fixation doit être réalisée par une personne compétente car cela nécessite des chevilles adaptées à la nature de votre mur.

EN For your safety: The unit should be secured to the wall. NB this should be carried out by a competent person as you must use the right rawl plug for your type of wall.

10 BWD
x4

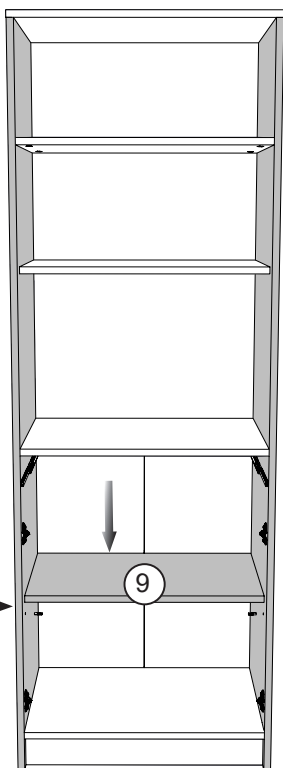
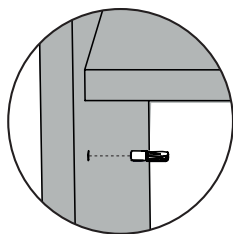
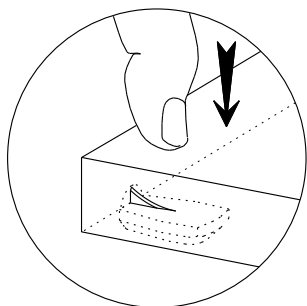
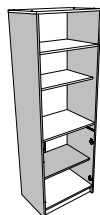

11 VR
x2

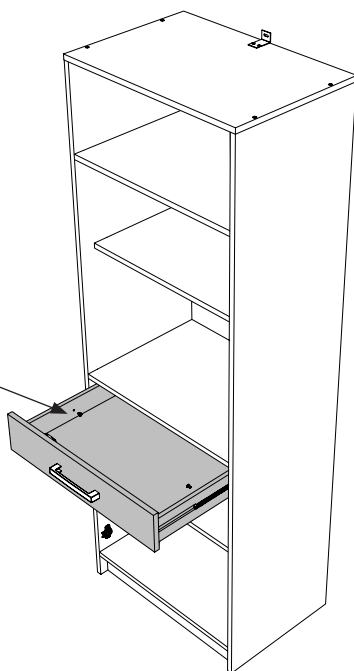
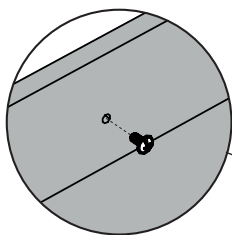
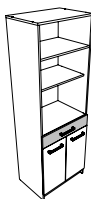

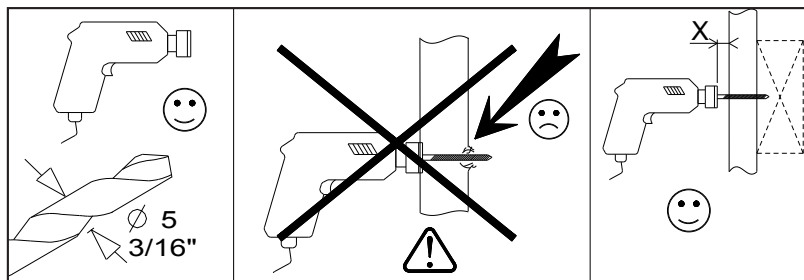
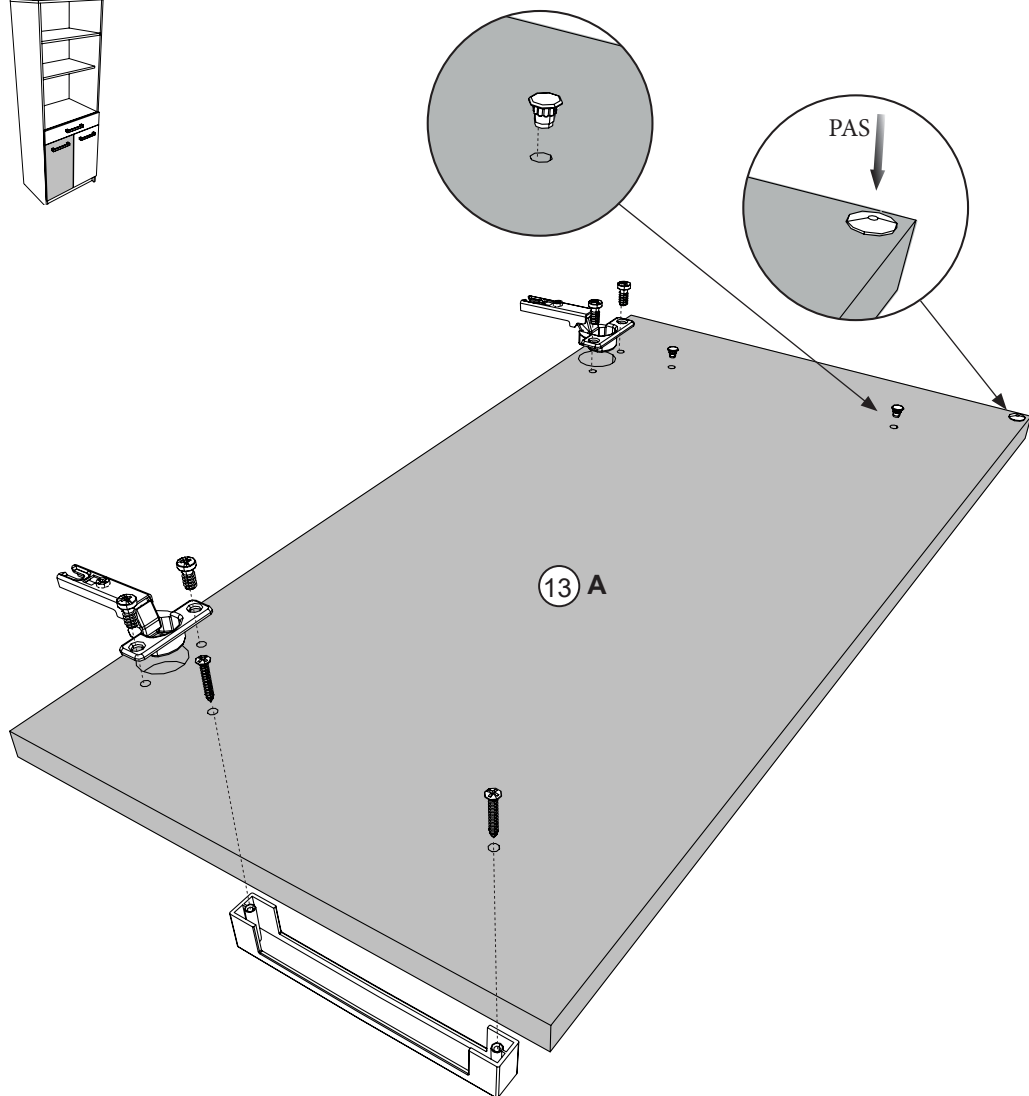
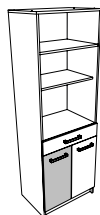
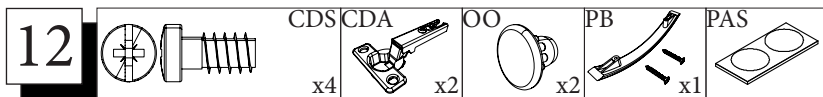

Exploded view diagram of the front panel assembly. The components and their quantities are:

- 13: Front Panel (x4)
- CDS: CDS Sensor (x2)
- CDA: CDS Amplifier (x2)
- OO: Optical Output (x2)
- PB: Push Button (x1)
- PAS: Passive Sensor (x1)

CD A



 x^2

x1

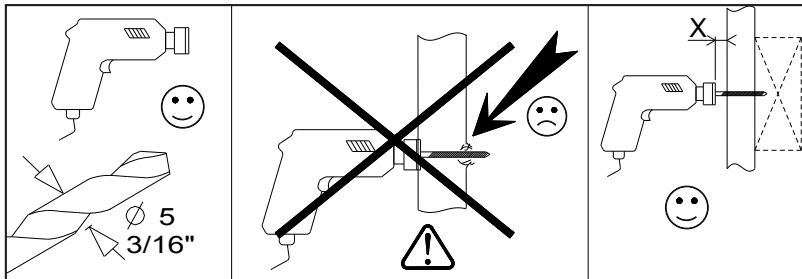
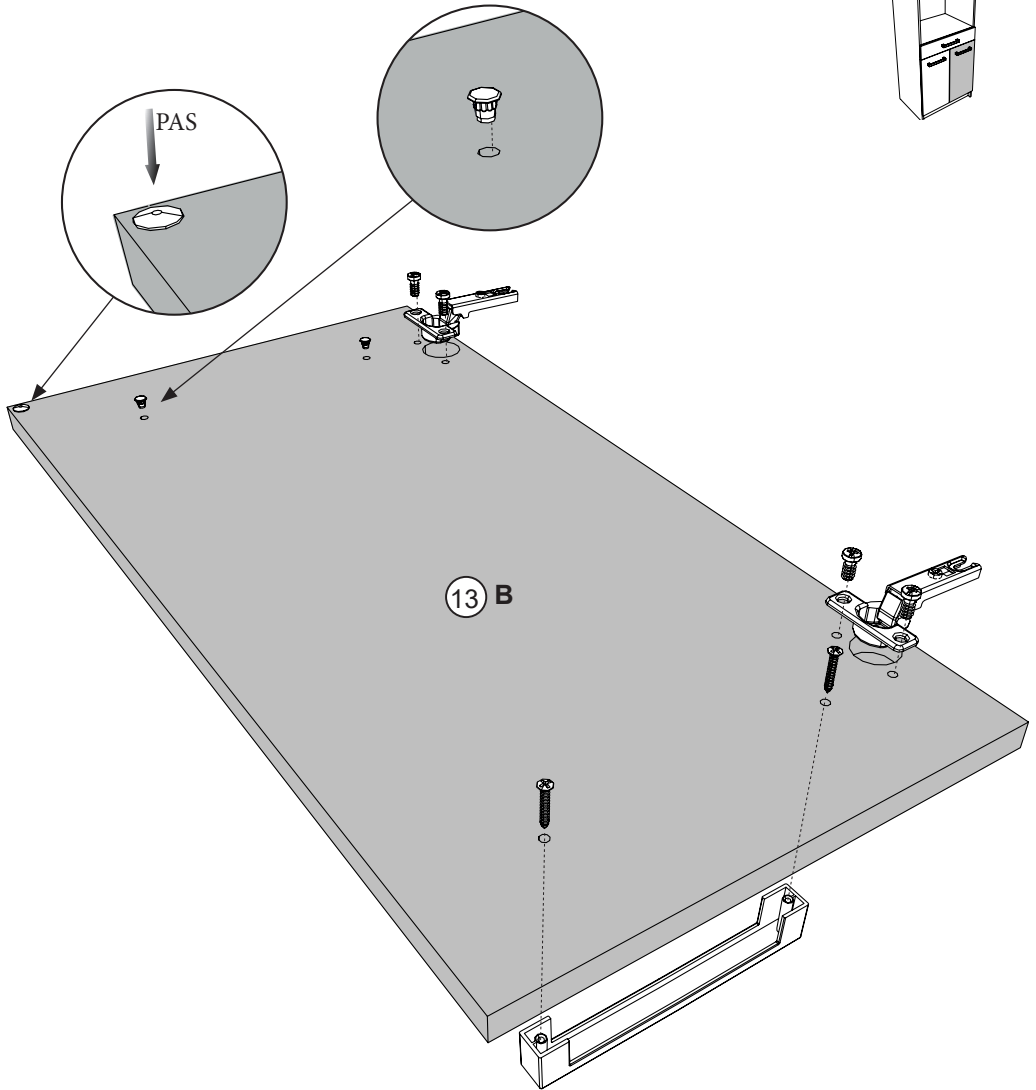
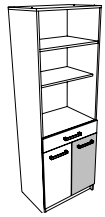

14

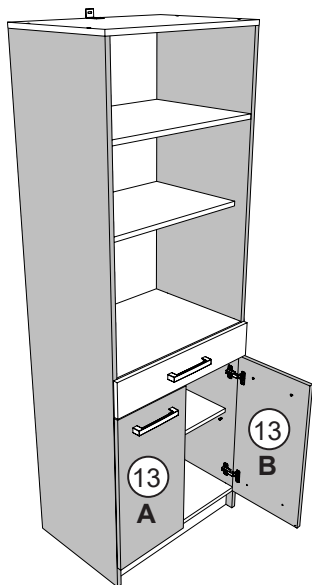
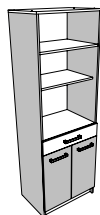

Charnières

<https://qrco.de/bc0wLm>

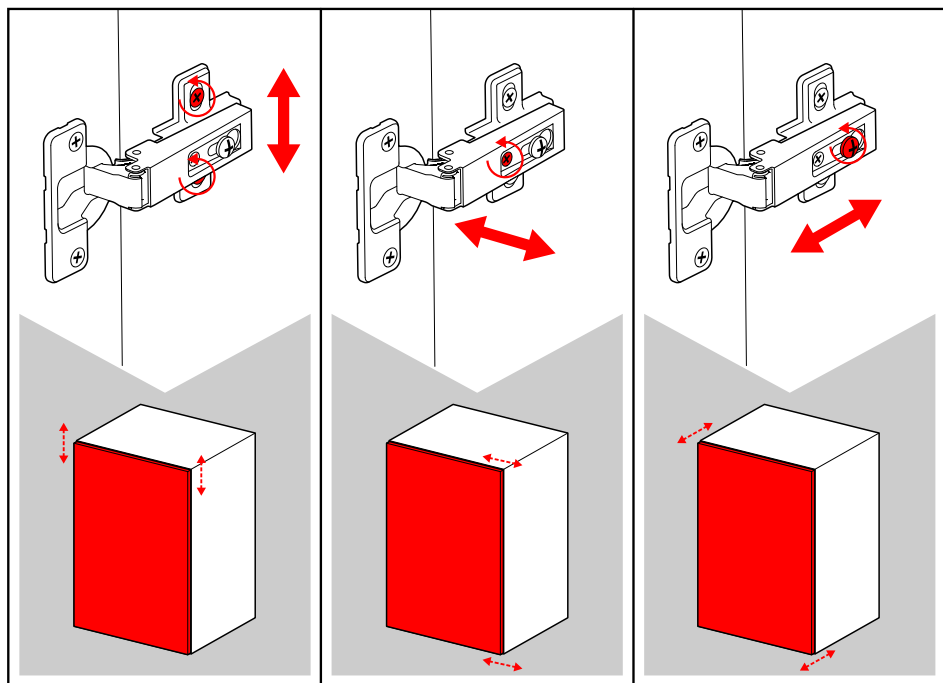

**LE TRI
+ FACILE**



**BAC
DE
TRI**



FR

**Pensez à
donner ou recycler.**



Association

OU



Magasin

OU



Déchèterie

<https://quefairedemesdechets.fr>